

This drawing is copyright and shall not be reproduced nor used for any other purpose without written permission of the author.

Do not copy from this drawing, use figured dimensions only.

The drawing must be read in conjunction with all other related drawings and documentation.

It is the contractor's responsibility to ensure compliance with the Building Regulations.

It is the contractor's responsibility to check all dimensions on site, any discrepancy to be reported immediately.

Details and sizes shown are indicative only and are subject to confirmation by the relevant Specialist Sub-contractor.

This drawing is not to be for Land Registry purposes.

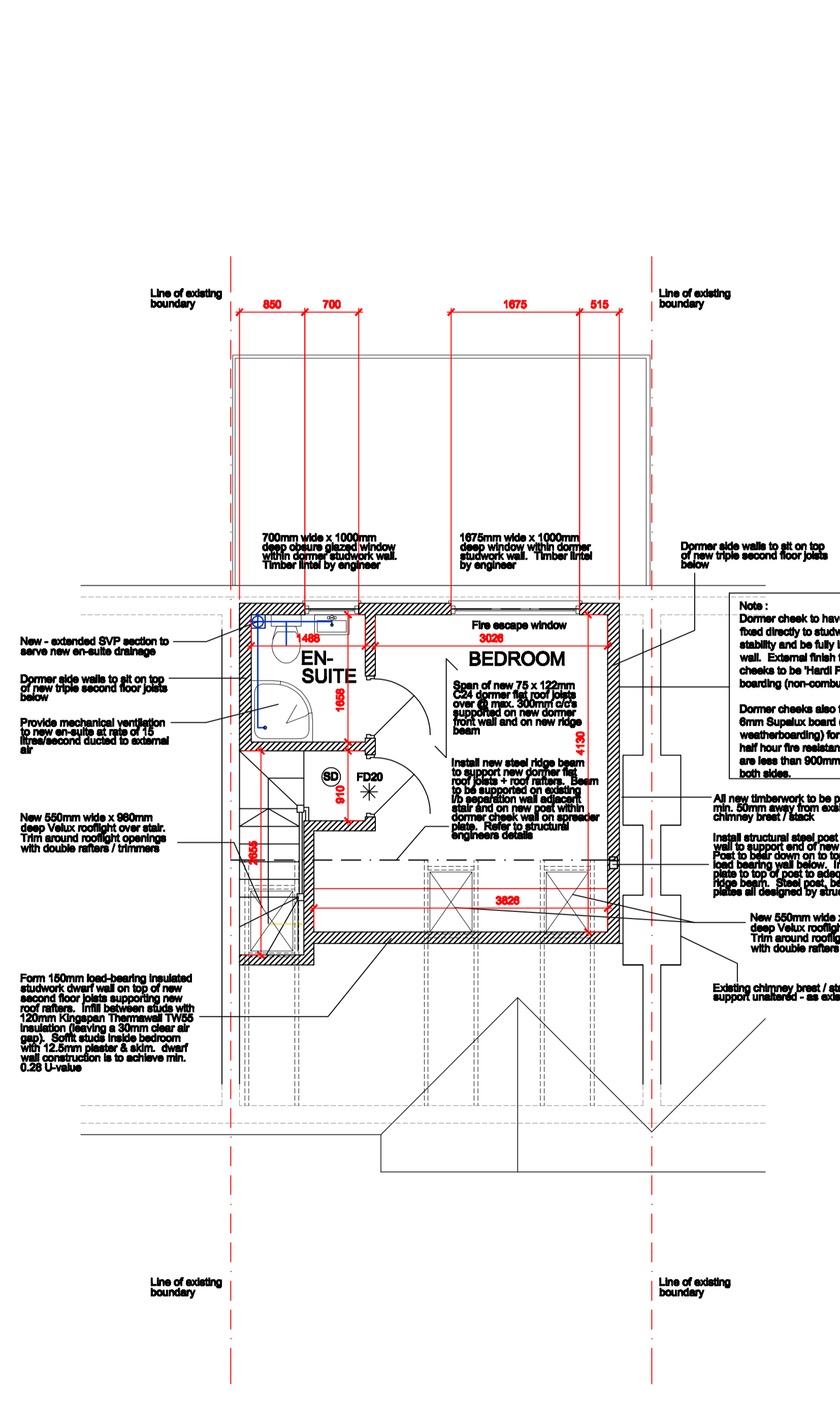
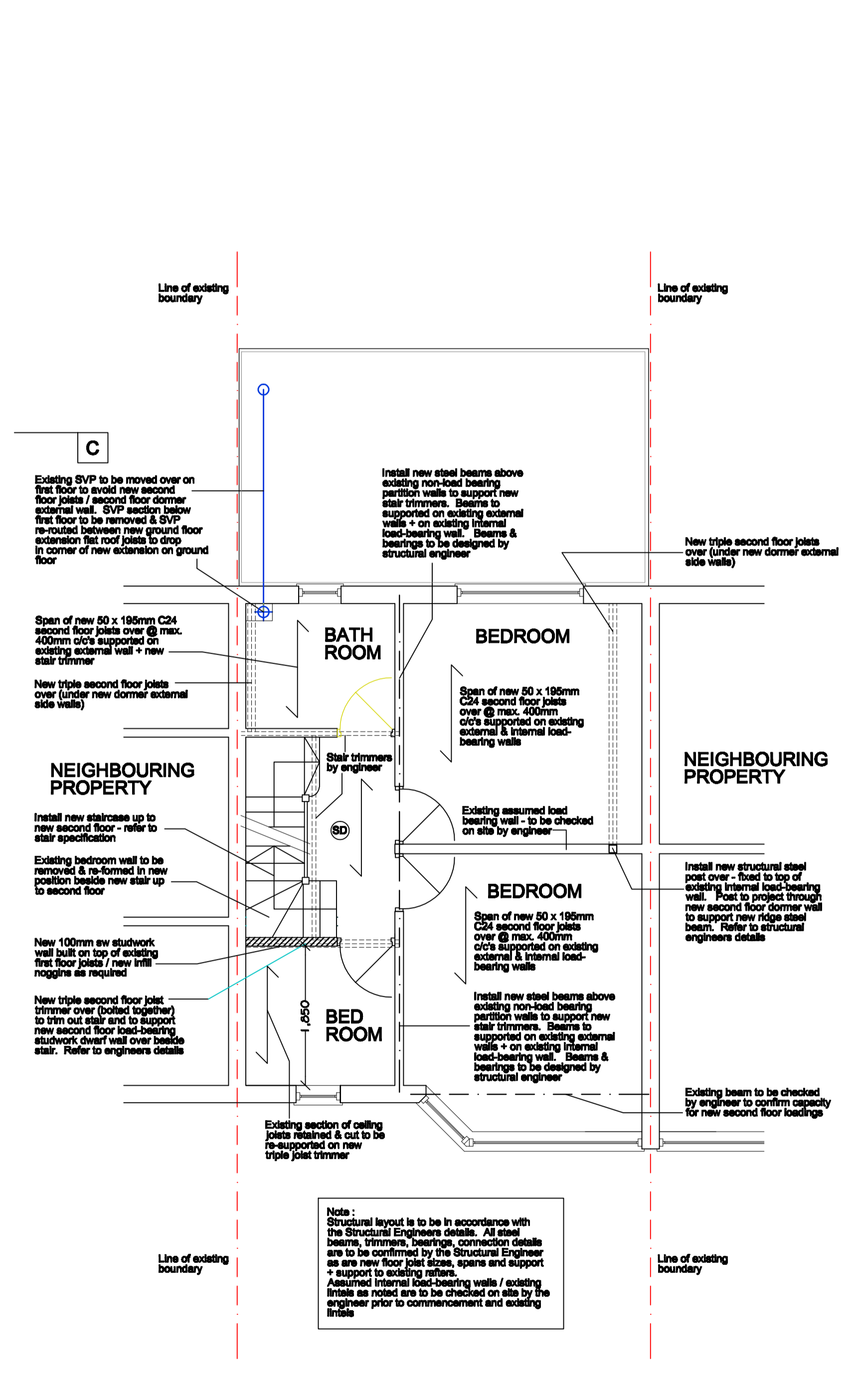
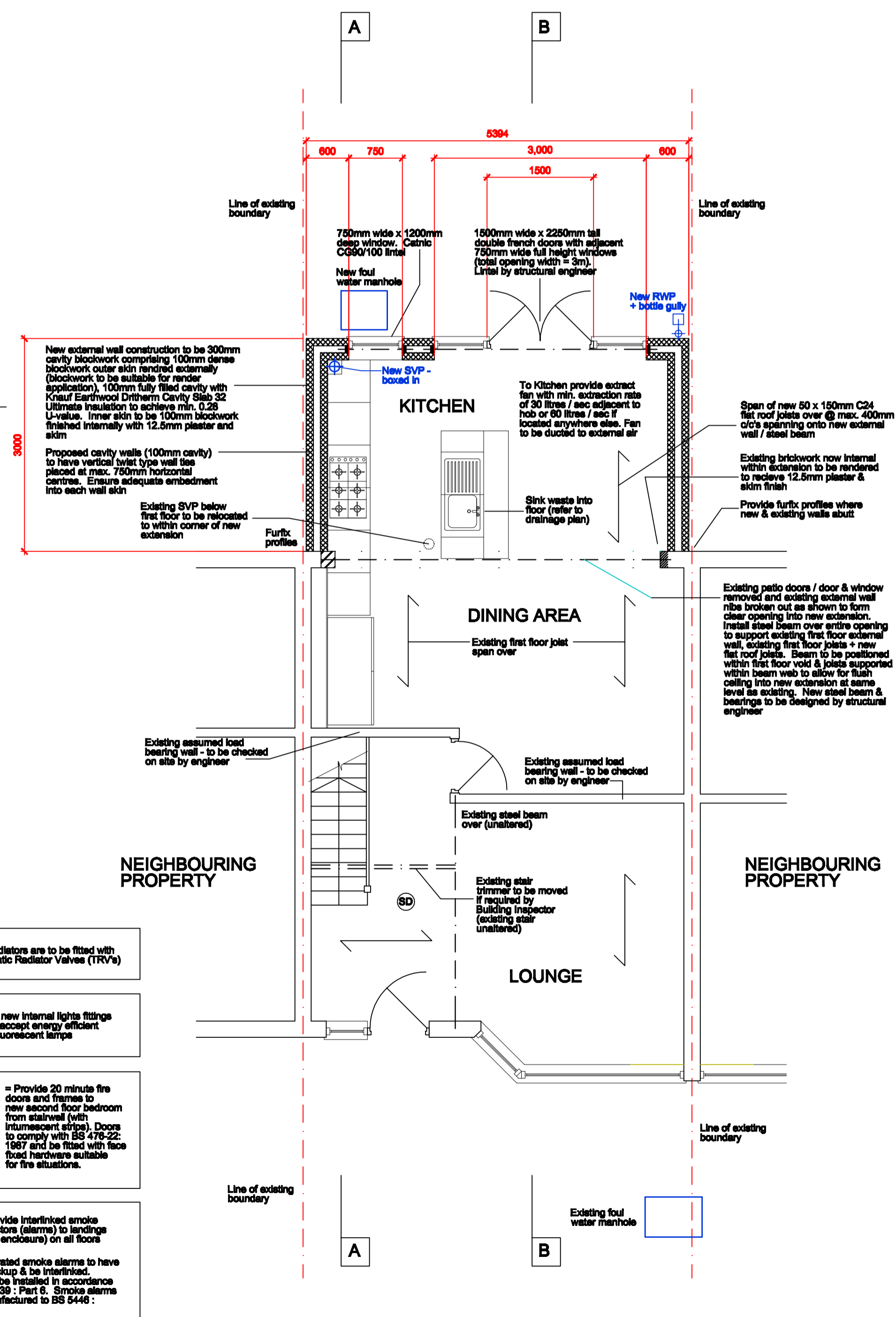

Note: All new radiators are to be fitted with Thermostatic Radiator Valves (TRVs)

Note: 25% of all new internal lights fittings must only accept energy efficient compact fluorescent lamps

* FD20 = Provide 20 minute fire doors and frames to new second floor bedroom from stairwell (with intumescent strips). Doors to comply with BS 476-22:1987 and be fitted with face fixed hardware suitable for fire situations.

SD = Provide interlinked smoke detectors (alarms) to landings (stair enclosures) on all floors

Main operated smoke alarms to have battery backup & be interlinked. System to be installed in accordance with BS 5833: Part 6. Smoke alarms to be manufactured to BS 5446: Part 1.

ADP
Architectural Design & Plan

The Warren
21 Grange Road
Runwell
Wickford
essex
SS11 7LZ

t 01288 761611
f 01288 462750

e: mail@architecturaldesignandplan.com
w: www.architecturaldesignandplan.com

Client: MR D. IRVING
Project: 12 SALTASH ROAD ILFORD LONDON IG6 2NL

Description: PROPOSED REAR EXTENSION AND LOFT CONVERSION WITH DORMER

PROPOSED PLANS & ELEVATIONS

Status: CONSTRUCTION

Scale: A1@1:100/1:50
Date: JUL 2012

Job number: ADP14BRG
Drawing no.: 02